

**HSF**

**NOTES:**

Rated Current: 9.5AMP  
 Rated Voltage: 300V  
 Contact Resistance: 20mΩ Max  
 Withstand Voltage: 1600V AC  
 Insulation Resistance: 1000MΩ Min  
 Operation Temperature: -40°C to +120°C

Contact Material: Copper Alloy  
 Contact plating: 100u" Tin over 50u" nickel  
 Insulator Material: PBT,UL94V-0,BK

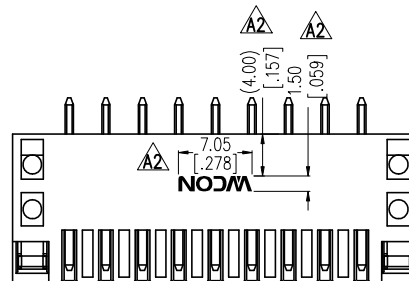
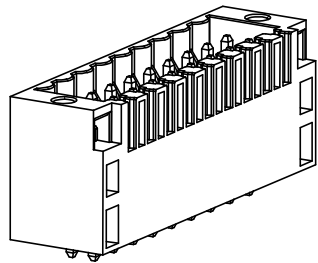

W/T WCON  $\Delta 2$

Recommended P.C.B Layout(Top Side)  
 (PCB BOARD TOLERANCE $\pm 0.05$ )

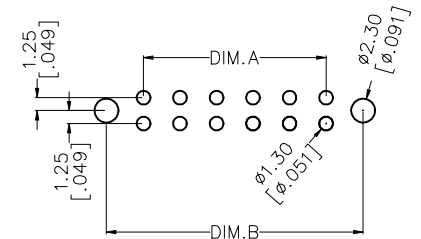

**Ordering Information**

PM350SW-2S XX X XX 2 N

No. of Pins    Color    Contact Plated    Blank=W/T WCON  
 B=BLACK    SM=Matte Sn    N=W/O WCON  
 U=BLUE    SN=Bright Sn  
 G=GREEN  
 R=RED  
 .....  
 .....

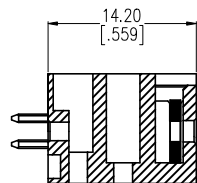

SECTION B-B  
 SCALE 1:1

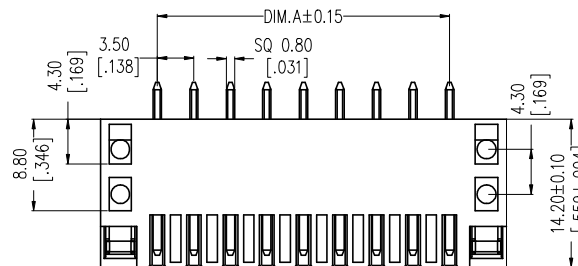

W/O WCON

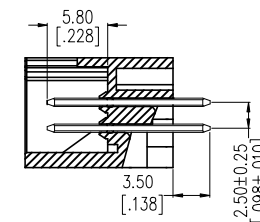
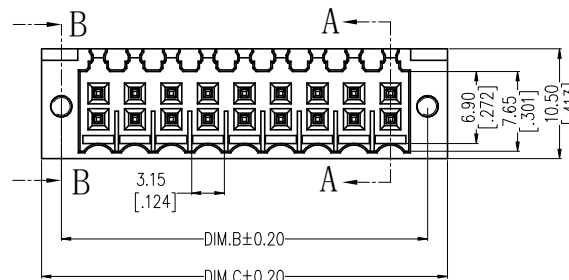

SECTION A-A  
 SCALE 1:1

No.Of PIN	DIM.A	DIM.B	DIM.C
2X2	3.50	10.60	14.40
2X3	7.00	14.10	17.90
2X4	10.50	17.60	21.40
2X5	14.00	21.20	24.90
2X6	17.50	24.60	28.40
2X7	21.00	28.10	31.90
2X8	24.50	31.60	35.40
2X9	28.00	35.10	38.90
2X10	31.50	38.60	42.40
2X11	35.00	42.10	45.90
2X12	38.50	45.60	49.40
2X13	42.00	49.10	52.90
2X14	45.50	52.60	56.40
2X15	49.00	56.10	59.90
2X16	52.50	59.60	63.40
2X17	56.00	63.10	66.90
2X18	59.50	66.60	70.40
2X19	63.00	70.10	73.90
2X20	66.50	73.60	77.40
2X21	70.00	77.10	80.90
2X22	73.50	80.60	84.40
2X23	77.00	84.10	87.90

REV	DATE	MODIFICATION DESCRIPTION	CHANGE	OPERATION	DRAW	DATE	SCALE	FIT	PART NO.
A2	2022/04/27	Add W/T WCON SPEC. & P/N	XSR	x.x ±0.40	XSR	2022/04/27	UNIT	mm	PM350SW-2SXXXXX2(N) $\Delta 2$
A1	2021/12/22	Adjust the size	GH	x.xx ±0.25	CHECK	DATE	SIZE	A4	TITLE: 3.50*2.50mm Pluggable Terminal Block Dual Row, Male, 180°DIP, W/T Nut Low Temperature Plastic
A0	2019/01/07	NEW	-----	x.xxx ±0.15	APPROVE	DATE	SHEET	1/2	Customer NO.
				Angle ± 3°			PROJ.		
				DIM TOL					

**WCON**  
 Http: www.wcon.com

WCON-Dongguan      WCON-Kunshan  
 Tel: +86 769 85358920      Tel: +86 512 57468408  
 Fax: +86 769 85358915      Fax: +86 512 57468468  
 E-mail: sales@wcon.com      E-mail: salesks@wcon.com