

HSF

TECHNICAL SPECS:

Current Rating:1.0AMP
 Contact Resistance:10mΩ Max
 Dielectric Strength: Min 1000V_{RMS}
 Mechanical Life: Min 100 cycles
 Mating Pin:Ø0.40 to Ø0.56mm
 Forces: (polished steel gauge Ø0.43mm)
 Insertion:200g Max/Pin,Withdrawal:60g Min/Pin
 Operation Temperature:-40°C to +105°C

Sleeve:Brass CuZn36Pb3(C36000),Sn over Ni
 Contact Clip(4 finger):BeCu(C17200),Au or Sn over Ni
 Insulator Material:PPS+30%G.F(UL94V-0)
 24P~32P Insulators with center one bar
 36P~48P Insulators with center two bar

Ordering Information

7110-302 XX M XX 074 X 1

Row of Pitch 2=15.24mm	No. of Pin See tab	Contact Plating S0=Gold Flash/Tin S3=10u"Gold/Tin S4=15u"Gold/Tin S5=30u"Gold/Tin SN=Tin	Packing T=Tube R=Tape&Reel
---------------------------	-----------------------	---	----------------------------------

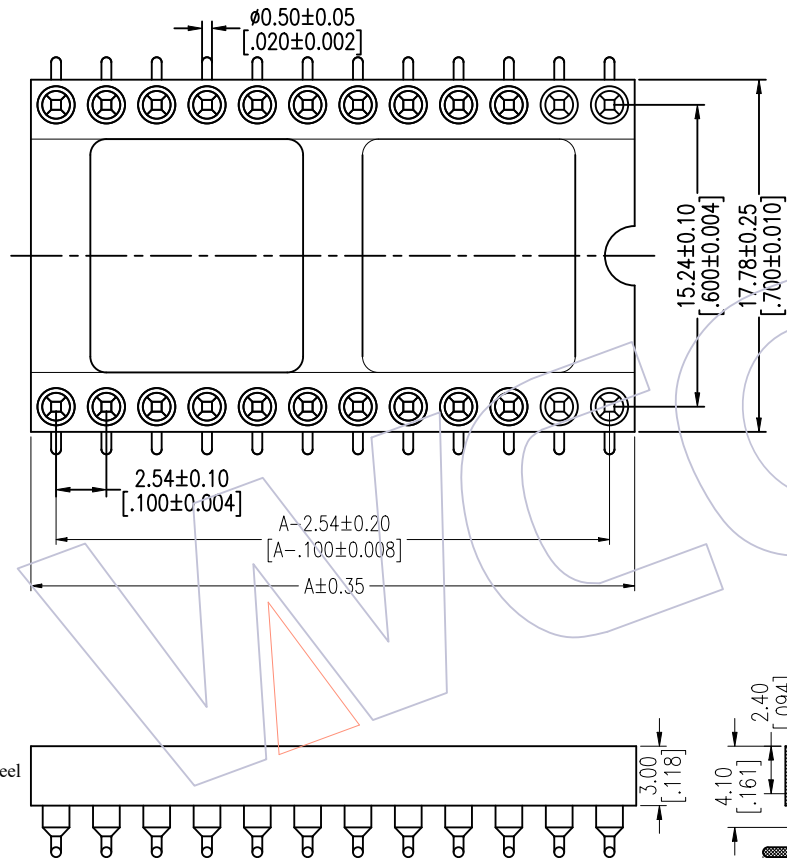

Recommended P.C.B Layout(Top Side)
 (PCB BOARD TOLERANCE±0.05)

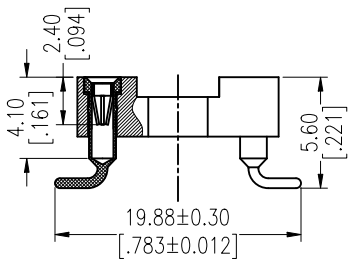
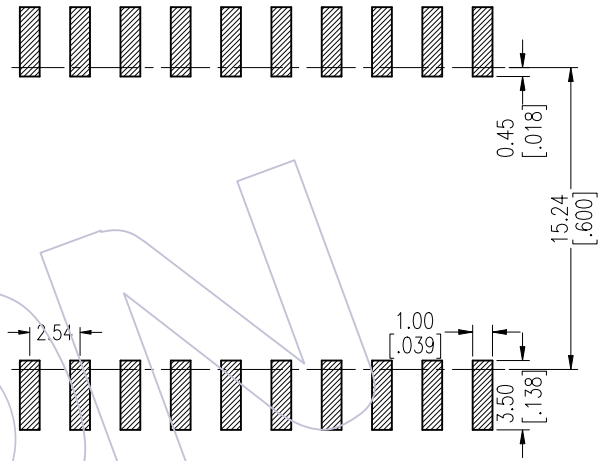

Dimensional & Ordering Information

NO.of Poles	Part No.	Dim
		A
24	7110-30224MXX074X1	30.48
28	7110-30228MXX074X1	35.56
32	7110-30232MXX074X1	40.64
36	7110-30236MXX074X1	45.72
40	7110-30240MXX074X1	50.80
42	7110-30242MXX074X1	53.34
48	7110-30248MXX074X1	60.96

REV	DATE	MODIFICATION DESCRIPTION	CHANGE	OPERATION	DRAW	DATE	SCALE	FIT	PART NO.
AO	2012/11/02	NEW	-----	X.X	JYHuang	2012/11/02	UNIT	mm	7110-302XXMXX074X1
				X.XX	CHECK	DATE	SIZE	A4	TITLE:
				X.XXX	APPROVE	DATE	SHEET	1/1	2.54mm IC SOCKET SMT H=3.0 L=7.43
				Angle			PROJ.		Row of Pitch 15.24mm
				DIM	TOL				Customer NO.

WCON

Http: www.wcon.com

WCON-Dongguan Tel: +86 769 85358920 Fax: +86 769 85358915 E-mail: sales@wcon.com

WCON-Kunshan Tel: +86 512 57468408 Fax: +86 512 57468468 E-mail: salesks@wcon.com