

NOTES:

Rated Current:9.0A
 Contact Resistance:30mΩ max
 Withstand Voltage:1500V AC/Minute
 Insulation Resistance:1000MΩ min
 Operation Temperature:-25℃ to+85℃

Contact Material:Brass
 Contact Plating: Au Or Sn Over Ni
 Insulator Material:PA66(White Transparent
 UL94-V2 std)Or PA46(Natural UL94-V0)

PART NO.	PIN	A	B	Material
WF4201-2WSHXXXX4	2*5P 及以下	+0.30 -0.10	+0.40 -0.20	PA46
WF4201-2WSXXXX4	2*5P 以上	+0.50 -0.00	+0.60 -0.00	PA66



Recommended P.C.B Layout(Top Side)
 (PCB BOARD TOLERANCE±0.05)

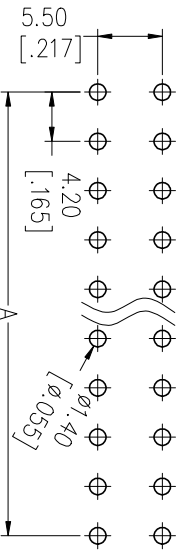

Ordering Information

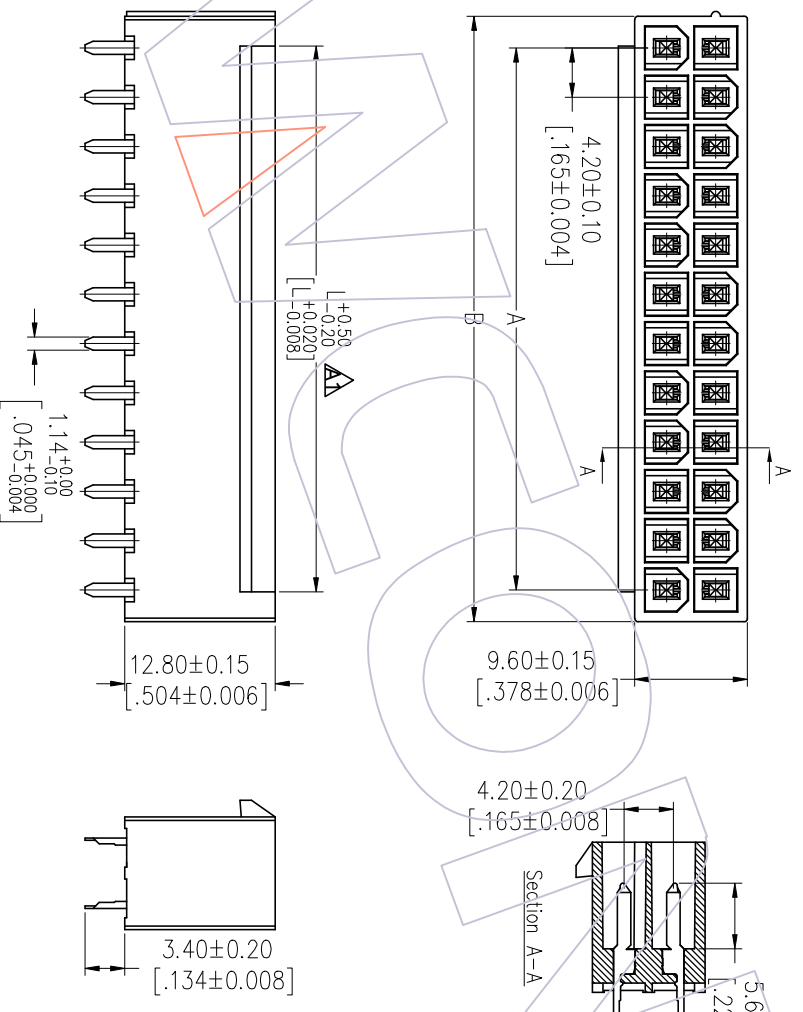
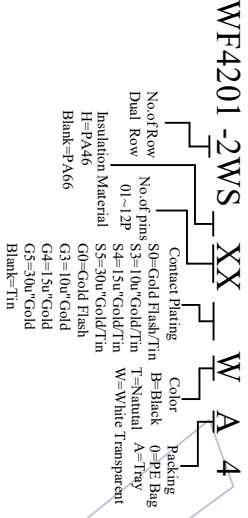

Dimensional & Ordering Information

Circuit	Part No.	Dimension		
		A	B	L
2x01	WF4201-2WS01W04	---	5.40	4.20
2x02	WF4201-2WS02W04	4.20	9.60	4.20
2x03	WF4201-2WS03W04	8.40	13.80	8.70
2x04	WF4201-2WS04W04	12.60	18.00	12.90
2x05	WF4201-2WS05W04	16.80	22.20	17.10
2x06	WF4201-2WS06W04	21.00	26.40	21.30
2x07	WF4201-2WS07W04	25.20	30.60	25.50
2x08	WF4201-2WS08W04	29.40	34.80	29.70
2x09	WF4201-2WS09W04	33.60	39.00	33.90
2x10	WF4201-2WS10W04	37.80	43.20	38.10
2x11	WF4201-2WS11W04	42.00	47.40	42.30
2x12	WF4201-2WS12W04	46.20	51.60	46.50



WCON-Dongguan
 Tel: +86 769 85358920
 Fax: +86 769 85358915
 E-mail: sales@wcon.com

WCON-Kunshan
 Tel: +86 512 57468408
 Fax: +86 512 57468468
 E-mail: sales@wcon.com

Http: www.wcon.com

OPERATION	DRAW	DATE	SCALE	FIT	PART NO.
XX	Ding	2019/05/15	mm	SEE TAB	
XXX	CHECK	DATE	UNIT		
XXX	ANGLE	DATE	SIZE	A4	TITLE: 4.20 MINI FIT DUAL ROW 180° WITH LONG BUMP WITHOUT POST
XXX	APPROVE	DATE	SHEET	1/2	Customer NO.
XXX	CHANGE	DATE	PROJ.		

REV DATE MODIFICATION DESCRIPTION

REV	DATE	MODIFICATION DESCRIPTION
A1	2019/05/15	Modify
AO	2012/09/17	NEW