

# HSF

NOTES:  
 Rated Current: 7.0AMP.  
 Contact Resistance: 15mΩ Max.  
 Rated Voltage: 1000V AC  
 Operation Temperature: -40℃ to +125℃

Contact Material: Brass  
 Contact Plating: Au or Sn Over Ni  
 Insulator Body Material: PA9T UL94V-0 BK

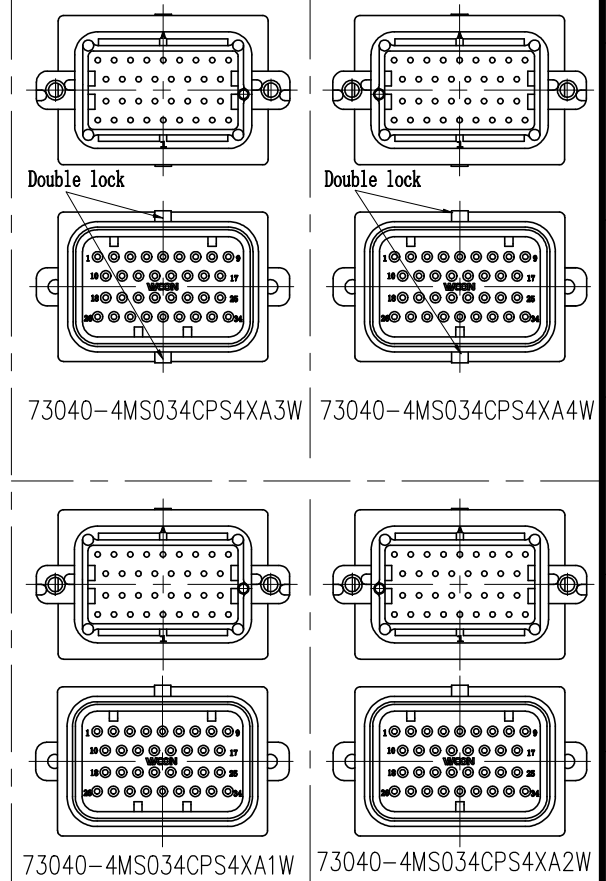
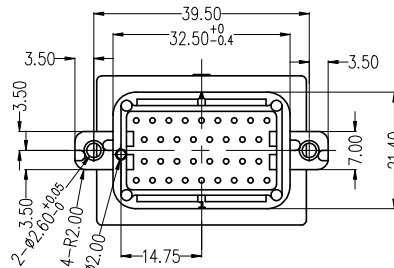
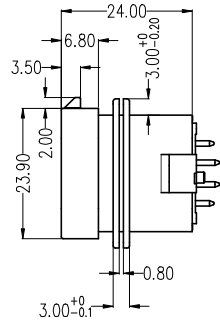
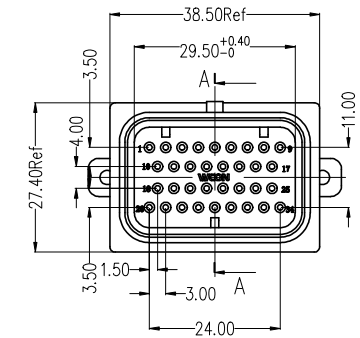
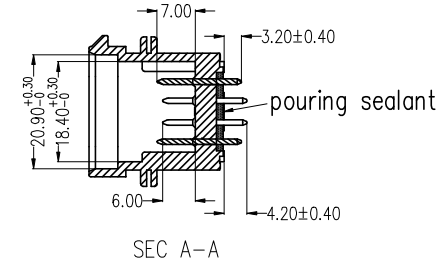
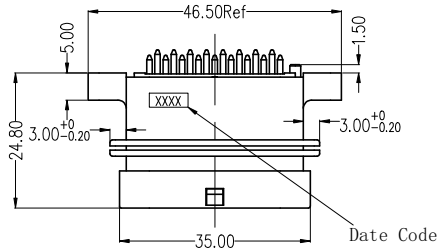
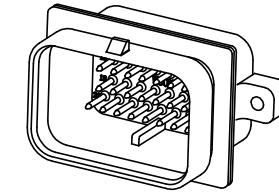

Recommended P.C.B Layout (Top Side)  
 (PCB BOARD TOLERANCE±0.05)

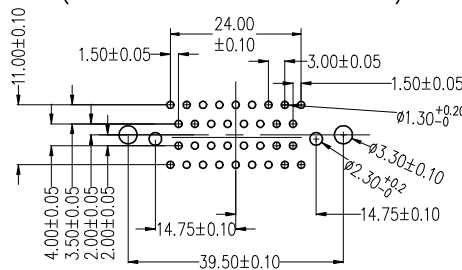

## Ordering Information

**7 30 40 - 4 M S 034 C P X X X A X W**

- 4: Four Row
- M: Male
- S: 180°
- No. of pins  
026=26P  
034=34P
- Insulator Material  
C=PA9T
- P: Brass
- W: Witch WCON LOGO
- X: 1,2,3 ... wrial number
- A: Vacuum box
- B: Don't glue  
D: glue
- Contact Plating  
S4=15u"Gold/ Matte Tin

OPERATION	DRAW	DATE	SCALE	Fit	PART NO.
x.	±0.60	2021/10/25	UNIT	mm	73040-4MS034CPS4XAXW
x.x	±0.40	DATE	SIZE	[inch]	TITLE:
x.xx	±0.25	DATE	SHEET	A4	3.0X4.0mm Pitch,34P 180° SUPER SEAL CONNECTOR
Angle	± 3°	DATE	PROJ.	1/2	Customer NO.
DIM	TOL				

# WCON

Http: [www.wcon.com](http://www.wcon.com)

WCON-Dongguan      WCON-Kunshan

Tel: +86 769 85358920      Tel: +86 512 57468408

Fax: +86 769 85358915      Fax: +86 512 57468468

E-mail: [sales@wcon.com](mailto:sales@wcon.com)      E-mail: [salesks@wcon.com](mailto:salesks@wcon.com)

REV	DATE	MODIFICATION DESCRIPTION	CHANGE
AO	2021/10/26	NEW	-----