

HSF

Recommended P.C.B Layout(Top Side)
(PCB BOARD TOLERANCE±0.05)

NOTES:
 Rated Current:3.0A
 Contact Resistance:20mΩ max
 Withstand Voltage:1000V AC/Minute
 Insulation Resistance:1000MΩ min
 Operation Temperature:-25℃ to +85℃

Contact Material:Brass
 Contact Plating:Au Or Sn over Ni
 Insulator Material:PA9T+33%G.F (UL94V-0)

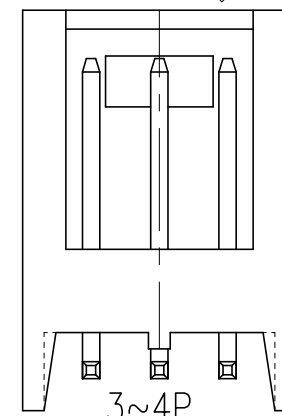
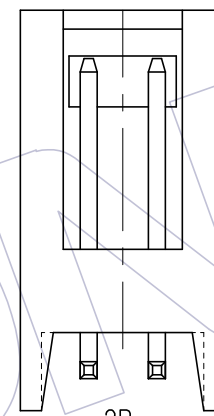
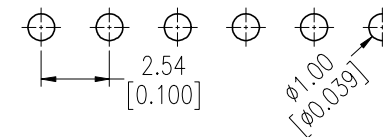
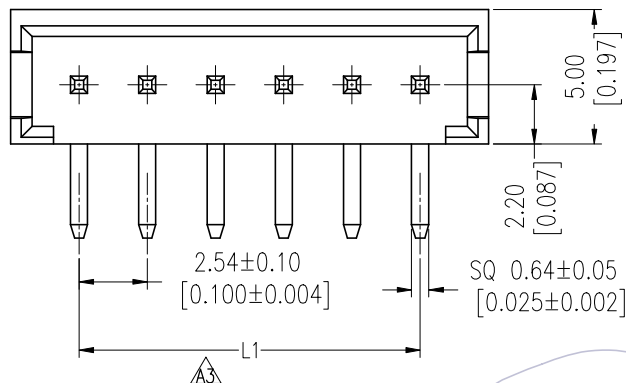

Ordering Information

WF2548 -1 WR XX X 0 1

No. of Row Single Row
 No. of pins 2P-22P
 Contact Plating S0=Gold Flash/Tin S3=10u"Gold/Tin S4=15u"Gold/Tin S5=30u"Gold/Tin G0=Gold Flash G3=10u"Gold G4=15u"Gold G5=30u"Gold Blank=Tin
 Color B=Black W=White
 Packing 0=PE Bag T=Tube

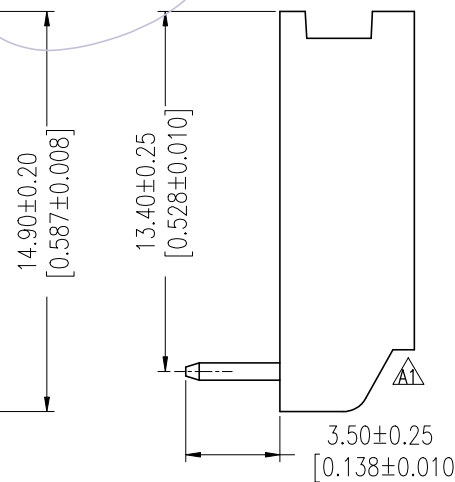
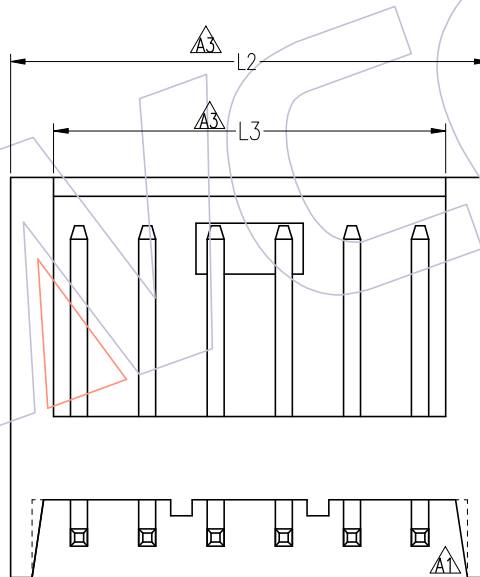

		L1	L2	L3
2-12P	L1	2.54xNo. of Positions-2.54±0.20 [0.100xNo. of Positions-0.100±0.008]	2.54xNo. of Positions+2.54±0.25 [0.100xNo. of Positions+0.100±0.010]	2.54xNo. of Positions-0.64±0.25 [0.100xNo. of Positions-0.025±0.010]
	L2			
	L3			
13-22P	L1	2.54xNo. of Positions-2.54±0.25 [0.100xNo. of Positions-0.100±0.010]	2.54xNo. of Positions+2.54±0.30 [0.100xNo. of Positions+0.100±0.012]	2.54xNo. of Positions-0.64±0.30 [0.100xNo. of Positions-0.025±0.012]
	L2			
	L3			

5P及以上

REV	DATE	MODIFICATION	DESCRIPTION	CHANGE	OPERATION	DRAW	DATE	SCALE	FIT	PART NO.
A3	2018/02/05		Modify		OPERATION	DRAW	2018/02/05	UNIT	mm	WF2548-1WRXXX01
A2	2017/02/28		Modify		x.X ±0.40	Ruipeng		SIZE	A4	
A1	2015/07/27		Modify		x.XX ±0.25	CHECK		SHEET	1/1	TITLE: 2.54 SINGLE ROW 90° DIP WAFER
A0	2012/09/08		NEW		x.XXX ±0.15	APPROVE		PROJ.		Customer NO.
					Angle ± 3'					
					DIM TOL					

WCON

Http: www.wcon.com

WCON-Dongguan Tel: +86 769 85358920
 WCON-Kunshan Tel: +86 512 57468408
 Fax: +86 769 85358915
 E-mail: sales@wcon.com

Fax: +86 512 57468468
 E-mail: salesks@wcon.com