

HSF

Recommended P.C.B Layout (Top Side)
(PCB BOARD TOLERANCE ±0.05)

NOTES:
 Rated Current: 3.0AMP.
 Contact Resistance: 20mΩ Max.
 Withstand Voltage: 1000V AC/DC
 Insulation Resistance: 5000MΩ Min.
 Operation Temperature: -40°C to +105°C

Contact Material: Brass
 Contact Plating: Au Over Ni
 Insulator Material: PA9T+33%G.F UL94V-0 BK

Ordering Information

11320-21 16 XX S XXX C 0 XX Δ

Contact Plating
 G0=Gold Flash
 G3=10u"Gold
 G4=15u"Gold
 G5=30u"Gold

Pin Length
 L=A+B+32.0
 Standard: 420=42.0

Insulator Material
 C=PA9T

Packing
 0=PE Bag
 A=Tray

Series No.
 01~99

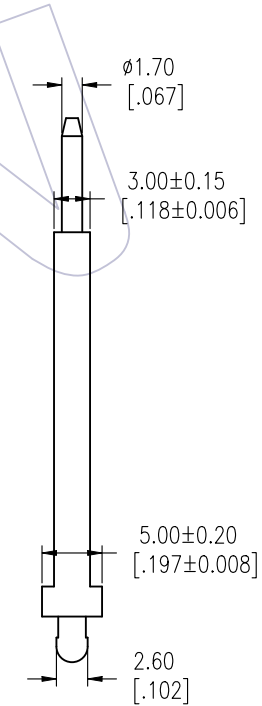
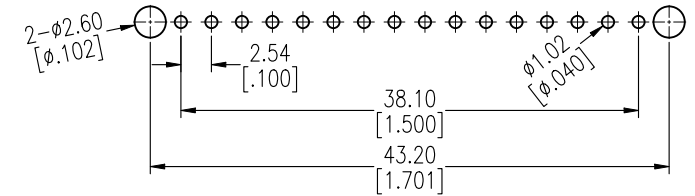
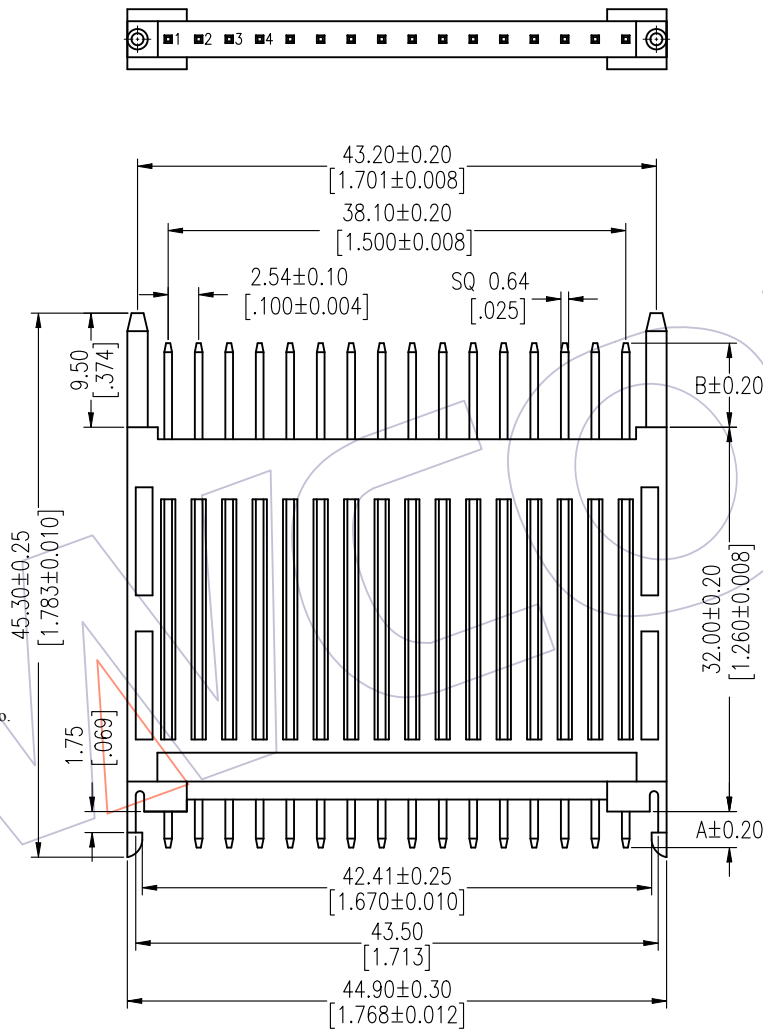

Item	Pin Length	A	B
Standard	42.00	3.00	7.00
Alternate			

OPERATION	DRAW	DATE	SCALE	Fit	PART NO.
x.x ±0.40	Ruipeng	2018/01/22	UNIT	mm	11320-2116XXSXXXX0XX
x.xx ±0.25	CHECK	DATE	SIZE	A4	TITLE:
x.xxx ±0.15	APPROVE	DATE	SHEET	1/1	PH2. 54 1*16P 180° H=32.0
Angle ± 3°			PROJ.		Customer NO.
DIM TOL					

WCON

Http: www.wcon.com

WCON-Dongguan
 Tel: +86 769 85358920
 Fax: +86 769 85358915
 E-mail: sales@wcon.com

WCON-Kunshan
 Tel: +86 512 57468408
 Fax: +86 512 57468468
 E-mail: salesks@wcon.com