

HSF

NOTES:
 Rated Current:3.0AMP.
 Contact Resistance:20mΩ Max.
 Withstand Voltage:1000V AC/DC
 Insulation Resistance:1000MΩ Min.
 Operation Temperature:-40°C to +105°C

Contact Material:Brass
 Contact Plating:Au or Sn Over Ni
 Insulator Material:PA9T+33%G.F UL94V-0 BK

Ordering Information

1125-11 XX XX M XXX C R XX $\triangle A1$

No. of Pins 02~40	Contact Plating G0=Gold Flash G3=10u"Gold G4=15u"Gold G5=30u"Gold S0=Gold Flash/Tin S3=10u"Gold/Tin S4=15u"Gold/Tin S5=30u"Gold/Tin SN=Tin SM=Matte Tin	Pin Length L=B+D+2.5+ $\frac{W}{2}$ Standard:082=8.2 102=10.2 111=11.1 115=11.5 136=13.6	Insulator Material C=PA9T	Packing T=Tube P=Tube+CAP R=Tape & Reel+CAP	Series No. 01~99
----------------------	---	--	------------------------------	--	---------------------

Item	Pin Length	W	E	B	Mating
Standard	8.20	5.00	3.34	3.00	2135
	10.20	5.00	3.34	5.00	2150
	11.10	5.00	3.34	5.90	2171 2185
	11.50	5.00	3.74	5.90	2171 2185
	13.60	5.00	3.74	8.00	
Alternate					

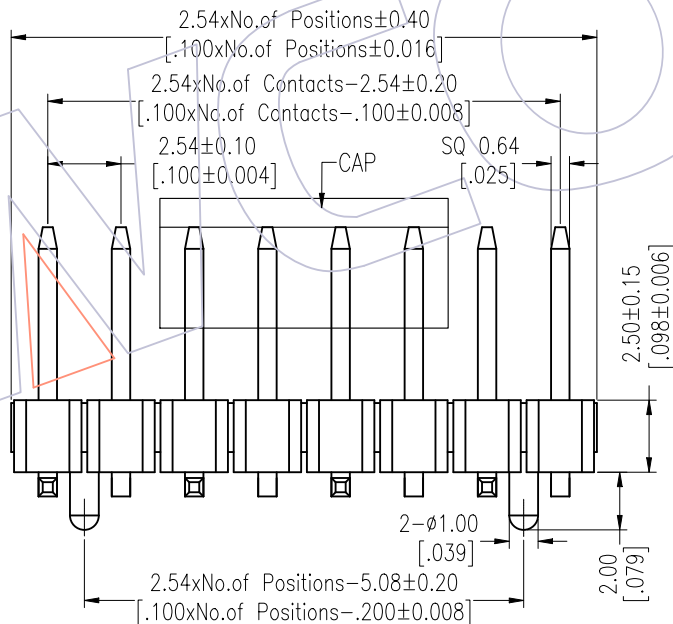
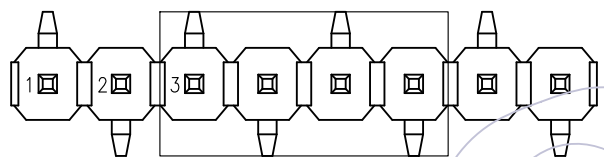
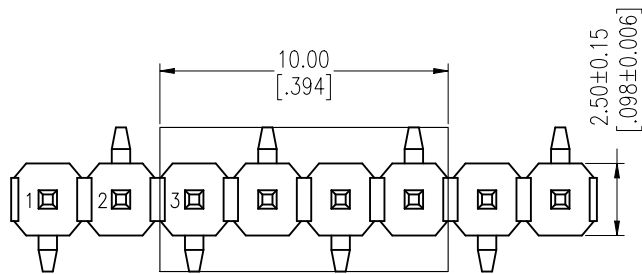

Recommended P.C.B Layout (Top Side)
 (PCB BOARD TOLERANCE±0.05)

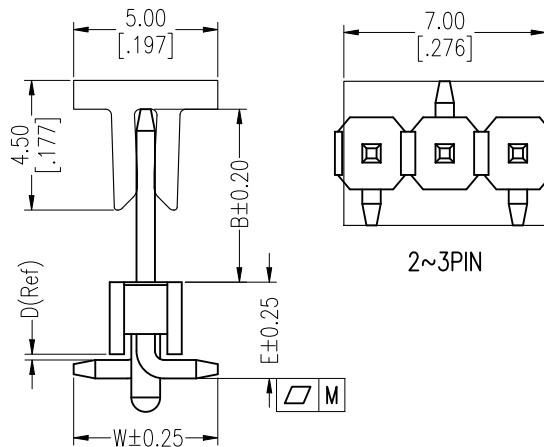
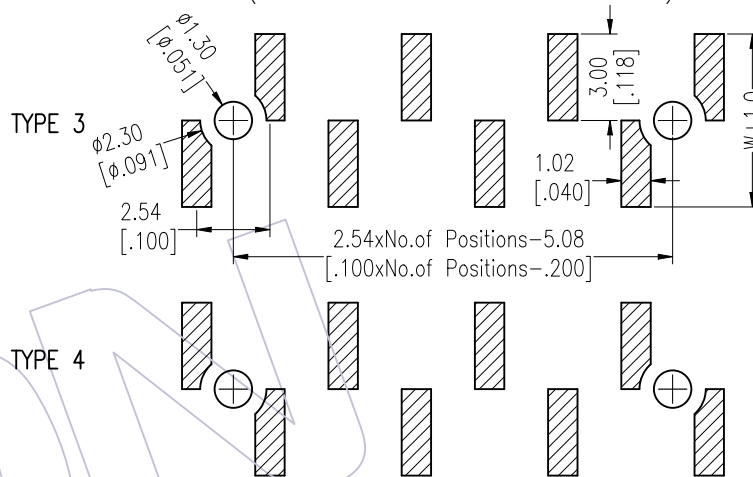

$\triangle A2$	PIN(PerRow)	2-15P	16-25P	26-40P
M		0.10	0.15	0.18

REV	DATE	MODIFICATION DESCRIPTION	CHANGE	OPERATION	DRAW	DATE	SCALE	Fit	PART NO.
A2	2023/02/03	Add Flatness	$\triangle A2$	DuYing	DuYing	2023/02/03	UNIT	mm	1125-11XXXXMXXRCRXX
A1	2018/01/22	Modify P/N	$\triangle A1$	Ruipeng	CHECK	DATE	SIZE	A4	TITLE: PH2.54 SINGLE ROW SMT H=2.5 WITH POST
A0	2012/05/17	NEW	-----	-----	APPROVE	DATE	SHEET	1/1	Customer NO.
				Angle	± 3'		PROJ.	ϕ	
				DIM	TOL				

WCON

Http: www.wcon.com

WCON-Dongguan Tel: +86 769 85358920 Fax: +86 769 85358915 E-mail: sales@wcon.com
 WCON-Kunshan Tel: +86 512 57468408 Fax: +86 512 57468468 E-mail: salesks@wcon.com