

HSF

Recommended P.C.B Layout (Top Side)
(PCB BOARD TOLERANCE ±0.05)

NOTES:
 Rated Current: 2.0AMP.
 Contact Resistance: 20mΩ Max.
 Withstand Voltage: 500V AC/DC
 Insulation Resistance: 1000MΩ Min.
 Operation Temperature: -40°C to +125°C(GOLD)
 -40°C to +105°C(TIN) $\Delta 2$
 Contact Material: Brass
 Contact Plating: Au or Sn Over Ni
 Insulator Material: PA9T+33%G.F UL94V-0 BK

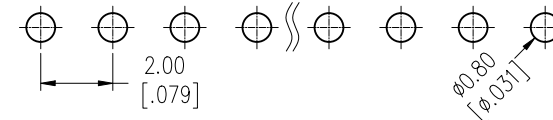
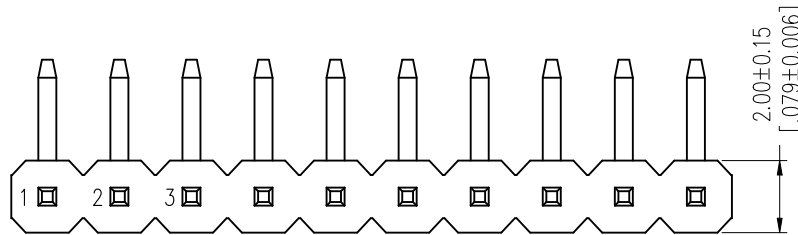

Ordering Information

1215-21 XX XX R XXX C 0 XX $\Delta 1$

$\Delta 3$ $\Delta 1$

No. of Pins	Contact Plating	Pin Length	Insulator	Packing	Series No.
02~40	G0=Gold Flash G3=10u"Gold G4=15u"Gold G5=30u"Gold S0=Gold Flash/Tin S3=10u"Gold/Tin S4=15u"Gold/Tin S5=30u"Gold/Tin SN=Tin SM=Matte Tin	L=A+B+C+D+1.0 Standard:	C=PA9T	0=PE Bag T=Tube	01~99

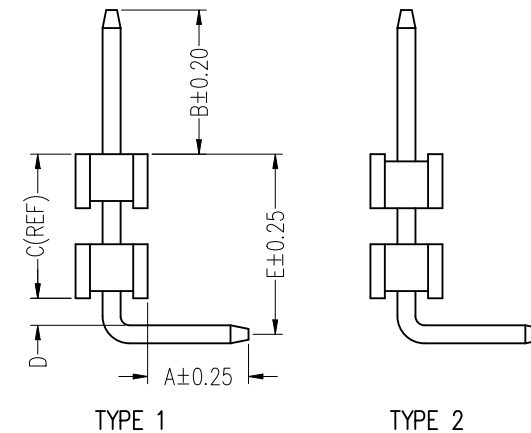
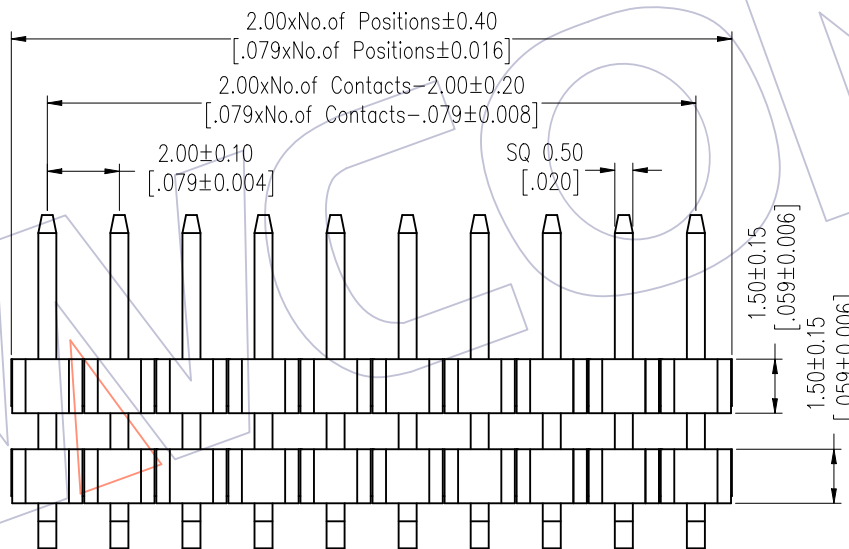

Item	Pin Length	A	D	B	E	Mating
Standard	---	2.80	0.75	4.00	---	2240 2243 2263 2272
Alternate						

A3	2020/06/12	Modify Pin 02~40P	$\Delta 3$	Du Ying	OPERATION	DRAW	DATE	SCALE	Fit	PART NO.
A2	2019/03/04	Modify	$\Delta 2$	Ding	x.X ± 0.40	Du Ying	2020/06/12	UNIT	mm	1215-21XXXXRXXXCOXX $\Delta 1$
A1	2018/01/18	Modify P/N	$\Delta 1$	-----	x.XX ± 0.25	CHECK	DATE	SIZE	A4	TITLE:
A0	2012/04/18	NEW	-----	-----	x.XXX ± 0.15	APPROVE	DATE	SHEET	1/1	PH2.00 SINGLE ROW DOUBLE PLASTIC 90° H=1.5 CONCAVE BENDING
REV	DATE	MODIFICATION DESCRIPTION	CHANGE		Angle ± 3°			PROJ.		Customer NO.
					DIM TOL					

WCON
 Http: www.wcon.com
 WCON-Dongguan Tel: +86 769 85358920
 WCON-Kunshan Tel: +86 512 57468408
 Fax: +86 769 85358915
 Fax: +86 512 57468468
 E-mail: sales@wcon.com
 E-mail: salesks@wcon.com